



SUCTION ACCUMULATOR SERIES A

General information

The A series suction accumulator protects the compressor from liquid slugging and can be used with all common refrigerants.

Features

- Hermetic design
- ODF copper fittings for easy brazing
- Corrosion resistant epoxy powder coating
- Internal orifice with strainer for optimum oil return
- Temperature range TS: -45 ... +65 °C
-  marking according to PED for certain types
-  LISTED : No. SA 10225

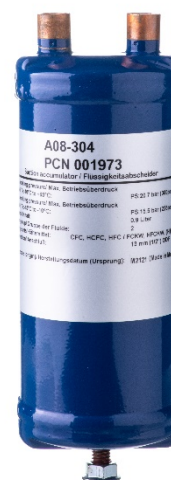
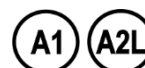



A08-304

Type code

A	XX	-	X	XX
Product Line Suction Accumulators				
Nominal Shell Length (~inch) 06 11 17 08 12 20 09 13 25 10 14		ODF Connection 04: 1/2" 09: 1-1/8" 05: 5/8" (16 mm) 11: 1-3/8" (35 mm) 07: 7/8" (22 mm) 13: 1-5/8"		
		Nominal Shell Diameter 6: approx. 15 cm 5: approx. 13 cm 4: approx. 10 cm 7: approx. 15 cm		

Technical Data

Max. allowable Pressure PS at TS: -10...+65 °C at TS: -45...-10 °C	20.7 bar 15.5 bar
Temperature Range TS	-45...+65 °C
Solder connections	copper, ODF
Material Shell	steel
Paint	Epoxy powder paint
Package	individual
Date code on label	Myyww (M - Made in Mexico, yy- year, ww - week of production)

Refrigerants	 Fluid group II: R134a, R404A, R407C, R410A, R448A, R449A, R450A, R452A, R507, R513A, R1234ze*  Fluid group I: (no UL) R32, R444B, R447A, R452B, R454B, R454A, R454C, R455A, R1234yf
NOTE:*) Fluid group acc. to PED., A2L acc. to ASHARE	
Markings	see Selection Tables

Quick selection – A1 / A2L Refrigerants

Type	Part No.	Connection		Released Refrigerants		Markings					Volume (l)
		(mm)	(Inch)	A1	A2L	Conformity Assessment	CE	UK CA	UL US LISTED	EAC	
A08-304	001973		1/2"	R134a		SEP	Not required	Not required	√	√	0.73
A10-305	001977	16	5/8"								0.93
A06-405	001989	16	5/8"								0.93
A12-305	001978	16	5/8"								1.16
A12-306	001979		3/4"								1.16
A14-305	001980	16	5/8"								1.40
A14-306	001987		3/4"								1.40
A10-405	001990	16	5/8"								1.75
A10-406	001994		3/4"								1.75
A09-506	881995		3/4"								R1234ze
A09-507	882455	22	7/8"	2.33							
A12-506	881996		3/4"	3.29							
A12-507	881998	22	7/8"	3.29							
A13-507	882007	22	7/8"	3.80							
A13-509	882011		1-1/8"	3.80							
A17-509	882012		1-1/8"	4.87							
A17-511	882013	35	1-3/8"	4.87							
A11-607	882014	22	7/8"	4.30							
A13-607	882015	22	7/8"	4.98							
A13-609	882019		1-1/8"	4.98							
A14-611	882020	35	1-3/8"	5.48							
A17-613	882022		1-5/8"	6.85							
A17-642	889023	42		6.85							
A20-613	882021		1-5/8"	8.21							
A25-613	882023		1-5/8"	Cat.II / Mod. D1	CE0036	pending	√	√	10.23		

Quick selection – A2L Refrigerants

Type	Part No.*	Connection		Released Refrigerants	Markings					Volume (l)
		(mm)	(Inch)	A2L	Conformity Assessment	CE	UK CA	UL US LISTED	EAC	
A08-304-L	882453		1/2"	R32	SEP	Not required	Not required	-	√	0.73
A10-305-L	882457	16	5/8"							0.93
A06-405-L	882462	16	5/8"							0.93
A12-305-L	882458	16	5/8"							1.16
A12-306-L	882459		3/4"							1.16
A14-305-L	882460	16	5/8"							1.40
A14-306-L	882461		3/4"							1.40
A10-405-L	882463	16	5/8"							1.75
A10-406-L	882464		3/4"							1.75
A09-506-L	881994		3/4"							R1234yf
A09-507-L	882456	22	7/8"	2.33						
A12-506-L	881997		3/4"	3.29						
A12-507-L	881999	22	7/8"	3.29						
A13-507-L	882000	22	7/8"	3.80						
A13-509-L	882001		1-1/8"	3.80						
A17-509-L	882002		1-1/8"	4.87						
A17-511-L	882003	35	1-3/8"	4.87						
A11-607-L	882004	22	7/8"	4.30						
A13-607-L	882005	22	7/8"	4.98						
A13-609-L	882006		1-1/8"	4.98						
A14-611-L	882008	35	1-3/8"	5.48						
A17-613-L	882009		1-5/8"	6.85						
A17-642-L	882010	42		6.85						
A20-613-L	882016		1-5/8"	8.21						

NOTE: *) Several types on request. Please contact EMERSON local sale offices.

Selection table - A1 / A2L Refrigerants (continued)

Type	Part No.	Nominal Capacity Qn (kW)																	
		R134a		R407C		R404A/ R507		R410A		R448A/ R449A		R450A		R513A		R452A		R1234ze	
		Max.	Min.	Max.	Min.	Max.	Min.	Max.	Min.	Max.	Min.	Max.	Min.	Max.	Min.	Max.	Min.	Max.	Min.
A08-304	001973	4.2	0.6	7.0	1.1	4.6	0.7	8.6	1.3	7.2	1.1	4.1	0.6	3.7	0.6	4.6	0.7	3.5	0.5
A10-305	001977	6.0	0.9	10.5	1.6	7.0	1.1	12.9	1.9	10.8	1.6	5.8	0.9	5.2	0.8	7.0	1.1	5.0	0.8
A06-405	001989	6.0	0.9	10.5	1.6	7.0	1.1	12.9	1.9	10.8	1.6	5.8	0.9	5.2	0.8	7.0	1.1	5.0	0.8
A12-305	001978	6.0	0.9	10.5	1.6	7.0	1.1	12.9	1.9	10.8	1.6	5.8	0.9	5.2	0.8	7.0	1.1	5.0	0.8
A12-306	001979	8.1	1.2	14.0	2.1	9.1	1.4	17.1	2.6	14.4	2.2	7.8	1.2	7.1	1.1	9.1	1.4	6.7	1.0
A14-305	001980	6.0	0.9	10.5	1.6	7.0	1.1	12.9	1.9	10.8	1.6	5.8	0.9	5.2	0.8	7.0	1.1	5.0	0.8
A14-306	001987	8.1	1.2	14.0	2.1	9.1	1.4	17.1	2.6	14.4	2.2	7.8	1.2	7.1	1.1	9.1	1.4	6.7	1.0
A10-405	001990	6.0	0.9	10.5	1.6	7.0	1.1	12.9	1.9	10.8	1.6	5.8	0.9	5.2	0.8	7.0	1.1	5.0	0.8
A10-406	001994	8.1	1.2	14.0	2.1	9.1	1.4	17.1	2.6	14.4	2.2	7.8	1.2	7.1	1.1	9.1	1.4	6.7	1.0
A09-506	881995	8.1	1.2	14.0	2.1	9.1	1.4	17.1	2.6	14.4	2.2	7.8	1.2	7.1	1.1	9.1	1.4	6.7	1.0
A09-507	882455	14.0	2.1	25.6	3.8	16.1	2.4	31.3	4.7	26.3	3.9	13.6	2.0	12.3	1.8	16.1	2.4	11.7	1.8
A12-506	881996	8.1	1.2	14.0	2.1	9.1	1.4	17.1	2.6	14.4	2.2	7.8	1.2	7.1	1.1	9.1	1.4	6.7	1.0
A12-507	881998	14.0	2.1	25.6	3.8	16.1	2.4	31.3	4.7	26.3	3.9	13.6	2.0	12.3	1.8	16.1	2.4	11.7	1.8
A13-507	882007	14.0	2.1	25.6	3.8	16.1	2.4	31.3	4.7	26.3	3.9	13.6	2.0	12.3	1.8	16.1	2.4	11.7	1.8
A13-509	882011	25.3	3.8	41.4	6.2	26.7	4.0	50.6	7.6	42.5	6.4	24.5	3.7	22.2	3.3	26.7	4.0	21.0	3.2
A17-509	882012	25.3	3.8	41.4	6.2	26.7	4.0	50.6	7.6	42.5	6.4	24.5	3.7	22.3	3.3	26.7	4.0	21.0	3.2
A17-511	882013	37.6	5.6	66.0	9.9	42.8	6.4	80.6	12.1	67.6	10.1	36.4	5.5	33.3	5.0	42.8	6.4	31.3	4.7
A11-607	882014	14.0	2.1	25.6	3.8	16.1	2.4	31.3	4.7	26.3	3.9	13.6	2.0	12.3	1.8	16.1	2.4	11.7	1.8
A13-607	882015	14.0	2.1	25.6	3.8	16.1	2.4	31.3	4.7	26.3	3.9	13.6	2.0	12.3	1.8	16.1	2.4	11.7	1.8
A13-609	882019	25.3	3.8	41.4	6.2	26.7	4.0	50.6	7.6	42.5	6.4	24.5	3.7	22.2	3.3	26.7	4.0	21.0	3.2
A14-611	882020	37.6	5.6	66.0	9.9	42.8	6.4	80.6	12.1	67.6	10.1	36.4	5.5	33.3	5.0	42.8	6.4	31.3	4.7
A17-613	882022	59.7	9.0	100.0	15.0	63.9	9.6	122.2	18.3	102.5	15.4	57.8	8.7	52.4	7.9	63.9	9.6	49.7	7.5
A17-642	889023	59.7	9.0	100.0	15.0	63.9	9.6	122.2	18.3	102.5	15.4	57.8	8.7	52.4	7.9	63.9	9.6	49.7	7.5
A20-613	882021	59.7	9.0	100.0	15.0	63.9	9.6	122.2	18.3	102.5	15.4	57.8	8.7	52.4	7.9	63.9	9.6	49.7	7.5
A25-613	882023	59.7	9.0	100.0	15.0	63.9	9.6	122.2	18.3	102.5	15.4	57.8	8.7	52.4	7.9	63.9	9.6	49.7	7.5

Selection table –A2L Refrigerants (continued)

Type	Part No.	Nominal Capacity Qn (kW)																	
		R32		R452B		R454A		R454B		R454C		R455A		R1234ze		R1234yf			
		Max.	Min.	Max.	Min.	Max.	Min.	Max.	Min.	Max.	Min.	Max.	Min.	Max.	Min.	Max.	Min.	Max.	Min.
A08-304-L	882453	11.0	1.7	5.1	0.8	7.2	1.1	5.4	0.8	8.2	1.2	7.9	1.2	3.5	0.5	3.6	0.5		
A10-305-L	882457	16.5	2.5	7.7	1.2	10.8	1.6	8.0	1.2	12.4	1.9	11.8	1.8	5.0	0.8	5.1	0.8		
A06-405-L	882462	16.5	2.5	7.7	1.2	10.8	1.6	8.0	1.2	12.4	1.9	11.8	1.8	5.0	0.8	5.1	0.8		
A12-305-L	882458	16.5	2.5	7.7	1.2	10.8	1.6	8.0	1.2	12.4	1.9	11.8	1.8	5.0	0.8	5.1	0.8		
A12-306-L	882459	22.0	3.3	10.3	1.5	14.4	2.2	10.7	1.6	16.5	2.5	15.8	2.4	6.7	1.0	6.9	1.0		
A14-305-L	882460	16.5	2.5	7.7	1.2	10.8	1.6	8.0	1.2	12.4	1.9	11.8	1.8	5.0	0.8	5.1	0.8		
A14-306-L	882461	22.0	3.3	10.3	1.5	14.4	2.2	10.7	1.6	16.5	2.5	15.8	2.4	6.7	1.0	6.9	1.0		
A10-405-L	882463	16.5	2.2	7.7	1.2	10.8	1.6	8.0	1.2	12.4	1.9	11.8	1.8	5.0	0.8	5.1	0.8		
A10-406-L	882464	22.0	3.3	10.3	1.5	14.4	2.2	10.7	1.6	16.4	2.5	15.8	2.4	6.7	1.0	6.9	1.0		
A09-506-L	881994	22.0	3.3	10.3	1.5	14.4	2.2	10.7	1.6	16.4	2.5	15.8	2.4	6.7	1.0	6.9	1.0		
A09-507-L	882456	40.2	6.0	18.8	2.8	26.2	3.9	19.5	2.9	30.1	4.5	28.8	4.3	11.7	1.8	12.1	1.8		
A12-506-L	881997	22.0	3.3	10.3	1.5	14.4	2.2	10.7	1.6	16.4	2.5	15.8	2.4	6.7	1.0	6.9	1.0		
A12-507-L	881999	40.2	6.0	18.8	2.8	26.2	3.9	19.5	2.9	30.1	4.5	28.8	4.3	11.7	1.8	12.1	1.8		
A13-507-L	882000	40.2	6.0	18.8	2.8	26.2	3.9	19.5	2.9	30.1	4.5	28.8	4.3	11.7	1.8	12.1	1.8		
A13-509-L	882001	64.9	9.7	30.3	4.5	42.4	6.4	31.6	4.7	48.7	7.3	46.6	7.0	21.0	3.2	21.7	3.3		
A17-509-L	882002	64.9	9.7	30.3	4.5	42.4	6.4	31.6	4.7	48.7	7.3	46.6	7.0	21.0	3.2	21.7	3.3		
A17-511-L	882003	103.4	15.5	48.3	7.2	67.5	10.1	50.3	7.5	77.5	11.6	74.2	11.1	31.3	4.7	32.3	4.8		
A11-607-L	882004	40.2	6.0	18.8	2.8	26.2	3.9	19.5	2.9	30.1	4.5	28.8	4.3	11.7	1.8	12.1	1.8		
A13-607-L	882005	40.2	6.0	18.8	2.8	26.2	3.9	19.5	2.9	30.1	4.5	28.8	4.3	11.7	1.8	12.1	1.8		
A13-609-L	882006	64.9	9.7	30.3	4.5	42.4	6.4	31.6	4.7	48.7	7.3	46.6	7.0	21.0	3.2	21.7	3.3		
A14-611-L	882008	103.4	15.5	48.3	7.2	67.5	10.1	50.3	7.5	77.5	11.6	74.2	11.1	31.3	4.7	32.3	4.8		
A17-613-L	882009	156.8	23.5	73.2	11.0	102.4	15.4	76.3	11.4	117.5	17.6	112.5	16.9	49.7	7.5	51.3	7.5		
A17-642-L	882010	156.8	23.5	73.2	11.0	102.4	15.4	76.3	11.4	117.5	17.6	112.5	16.9	49.7	7.5	51.3	7.5		
A20-613-L	882016	156.8	23.5	73.2	11.0	102.4	15.4	76.3	11.4	117.5	17.6	112.5	16.9	49.7	7.5	51.3	7.5		
A25-613-L	882017	-	-	-	-	-	-	-	-	-	-	-	-	49.7	7.5	-	-		

NOTE: The nominal capacities are based +4 °C evaporating temperature.

NOTE: For other operating conditions use the “Controls Navigator” or “Selection” tool (www.climate.emerson.com/en-gb).

Dimension (mm)

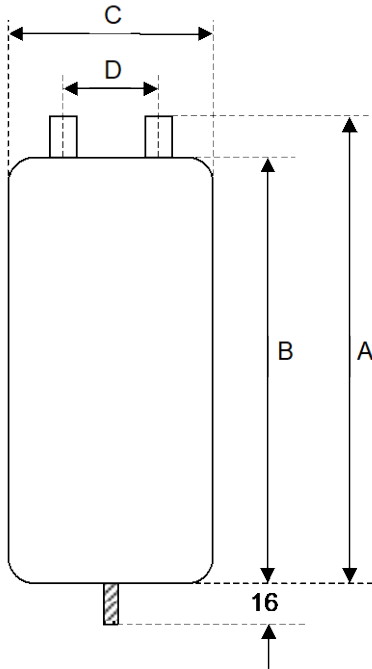

Type	Part No.	Connections		Dimensions (mm)			
		(mm)	(Inch)	A	B	C	D
A08-304	001973		1/2"	210	191	79	41
A10-305	001977	16	5/8"	266	238	79	41
A06-405	001989	16	5/8"	320	292	79	41
A12-305	001978	16	5/8"	325	292	79	41
A12-306	001979		3/4"	378	350	79	41
A14-305	001980	16	5/8"	383	350	79	41
A14-306	001987		3/4"	161	143	105	64
A10-405	001990	16	5/8"	168	143	105	64
A10-406	001994		3/4"	279	254	105	64
A09-506	881995		3/4"	285	254	105	64
A09-507	882455	22	7/8"	246	216	132	70
A12-506	881996		3/4"	252	216	132	70
A12-507	881998	22	7/8"	327	297	132	70
A13-507	882007	22	7/8"	334	297	132	70
A13-509	882011		1-1/8"	377	340	132	70
A17-509	882012		1-1/8"	380	340	132	70
A17-511	882013	35	1-3/8"	470	430	132	70
A11-607	882014	22	7/8"	471	430	132	70
A13-607	882015	22	7/8"	317	279	160	75
A13-609	882019		1-1/8"	358	320	160	75
A14-611	882020	35	1-3/8"	363	320	160	75
A17-613	882022		1-5/8"	396	350	160	75
A17-642	889023	42		480	432	160	75
A20-613	882021		1-5/8"	563	514	160	75
A25-613	882023		1-5/8"	683	635	160	75

DISCLAIMER

1. The contents of this publication are presented for informational purposes only and are not to be construed as warranties or guarantees, express or implied, regarding the products or services described herein or their use or applicability.
2. Emerson Climate Technologies GmbH and/or its affiliates (collectively "Emerson"), as applicable, reserve the right to modify the design or specifications of such products at any time without notice.
3. Emerson does not assume responsibility for the selection, use or maintenance of any product. Responsibility for proper selection, use and maintenance of any Emerson product remains solely with the purchaser or end user.
4. Emerson does not assume responsibility for possible typographic errors contained in this publication.